

# Synthetic Stucco Applications

## EIFS – EXTERIOR INSULATION AND FINISH SYSTEM

When installing Fypon products over an existing synthetic stucco (EIFS) surface, it is important to seal out any moisture that could collect and pool between the millwork and the synthetic stucco surface. Moisture will not harm the Fypon product; however, the surface of the synthetic stucco is susceptible to prolonged moisture pooling.

To prevent moisture problems, a high quality adhesive/sealant must be used. This type of adhesive/sealant not only bonds the millwork securely to the EIFS wall surface, but also creates a seal/gasket to prevent moisture entry behind the millwork.

1. Apply a solid bead of adhesive/sealant near the outside edge of the top and sides of the millwork. The bottom edge of the millwork should remain free of adhesive/sealant to allow moisture to escape.
2. Assess the area where the millwork will be positioned. If there is solid sheathing or framing behind the EIFS surface, millwork should be secured directly to it. However, if solid material cannot be located, the use of hollow wall fasteners will be needed. Fasteners should be kept inside the bead of adhesive/sealant.
3. When the millwork is placed snug against the wall surface, the bead of adhesive/sealant might ooze out the edges. Smooth out the bead and add additional adhesive/sealant to create a good weather proof seal that will repel water.

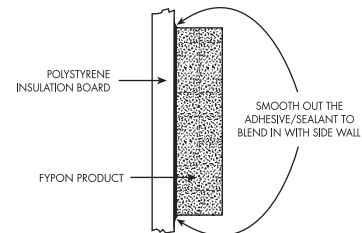
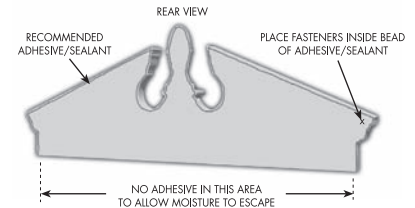
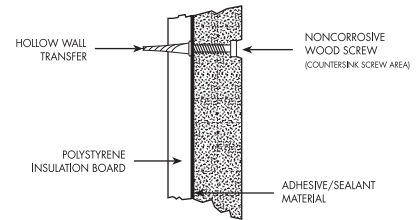
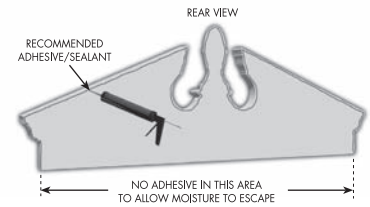

**USING CORROSION-RESISTANT FASTENERS AND PL PREMIUM ADHESIVE**  
 Always use corrosion-resistant mechanical fasteners (nails or screws) and PL Premium Adhesive when installing Fypon products. This combination provides a secure, long lasting bond. Countersink all fasteners about 1/8 inch and fill with exterior grade white spackle. If desired, sand any minor imperfections and topcoat with a quality exterior latex or oil base paint. Fypon exterior millwork installations should be finished using a quality, exterior grade silicone caulk to prevent water infiltration behind siding, windows and doors. Some exterior millwork installations, in particular new construction (before siding is applied) may require a J-channel and/or flashing to prevent water infiltration. Installers must determine which installation technique is best for the specific situation.

**IMPORTANT:**  
 Please read these installation guidelines thoroughly before beginning installation. Please note that these guidelines are provided only to assist with the installation of Fypon mouldings and millwork products. Modified procedures may be required in order to meet specific situations, unique applications and local building codes. The manufacturer does not under any circumstances warrant the installation of its products. Be sure to wear appropriate protective clothing, gloves and safety glasses when working with any tools. Installer should check for and relocate all electrical wiring within the proposed installation area, as needed (be sure to disconnect all electric power before working with any electrical wiring and follow all applicable local electrical codes and safety procedures).